



# SERIES PS

## Model PSF

MEGGA **Series PS** model PSF pumps are designed for dependable performance and rugged continuous duty service. When application requirements demand superior materials and performance in a horizontal close-coupled or frame mount design, choose the MEGGA **Series PS** model PSF.



### FEATURES:

Bulge formed, not stamped, from quality 304 stainless steel results in a strong fabrication and excellent resistance to corrosion.

Close-coupled and frame mounted configurations for maximum installation flexibility.

Back pull-out design for easy servicing with flanged suction and discharge.

Top centerline discharge helps deal with pipe loading and allows for self-venting of air.

High operating efficiency results in lower power consumption and smooth operation.

Industry standard motors and mechanical seals provide maximum product versatility.

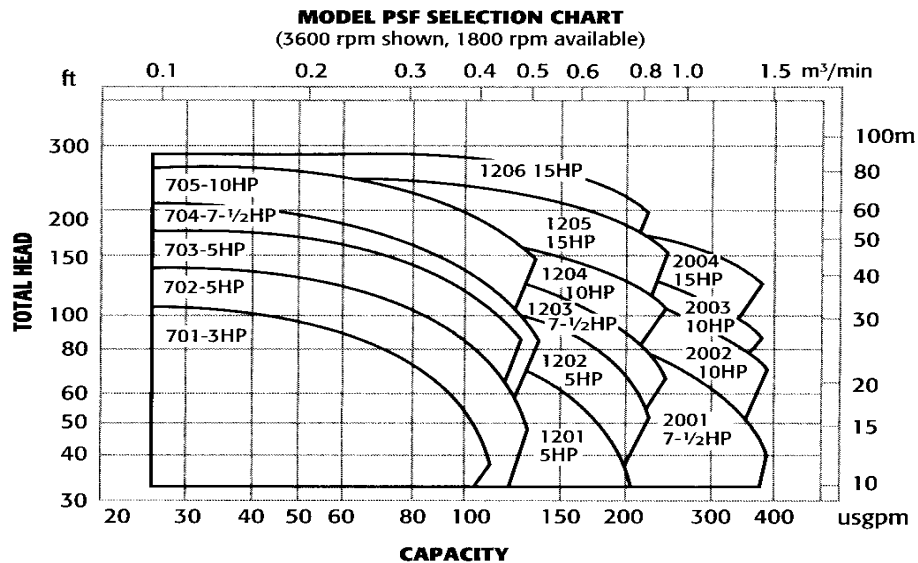

Distributed by:



**SERIES PS**  
**Specifications**  
**MODEL - PSF**

	<b>Standard</b>	<b>Optional</b>
<p><b>Size</b></p> <p>Suction (150 lb. ANSI R.F. Equivalent)</p> <p>Discharge (150 lb. ANSI R.F. Equivalent)</p> <p><b>H.P. Range</b></p> <p><b>Performance Range</b></p> <p>Capacity Head</p> <p><b>Liquid Handling</b></p> <p>Liquid Type Temperature</p> <p>Working Pressure</p> <p><b>Materials</b></p> <p>Casing Impeller (Closed Type) Shaft Bracket Mechanical Seal</p> <p><b>Direction of Rotation</b></p> <p><b>Motor</b></p> <p>Type Speed Single Phase</p> <p>Three Phase</p>	<p>PSF70: 2" ANSI PSF120: 2½" ANSI PSF200: 2½" ANSI</p> <p>PSF70: 1¼" ANSI PSF120: 1½" ANSI PSF200: 2" ANSI</p> <p>1 H.P. to 15 H.P.</p> <p>13 to 380 GPM at 3450 R.P.M. 33 to 285 feet at 3450 R.P.M.</p> <p>Various Dependent on Mechanical Seal Selection Max. 145 P.S.I.G. (10 Bar)</p> <p>304 Stainless Steel 304 Stainless Steel Stainless Steel Cast Iron Carbon vs. Ceramic (Buna Elastomers)</p> <p>Clockwise when viewed from motor end</p> <p>NEMA JM Frame 60Hz 3450 RPM (2 poles) TEFC: 1 H.P. to 10 H.P. ODP: 1 H.P. to 10 H.P. 115/208-230V TEFC: 1 H.P. to 15 H.P. ODP: 1 H.P. to 15 H.P. 208-230/460V and 575V</p>	<p>Various material options for high temperature, corrosive, and abrasive services.</p> <ul style="list-style-type: none"> <li>•Explosion Proof</li> <li>•1750 RPM for lower flows and pressures</li> </ul>



SERIES PS  
 Cross Section  
**MODEL - PSF**  
 Close-coupled

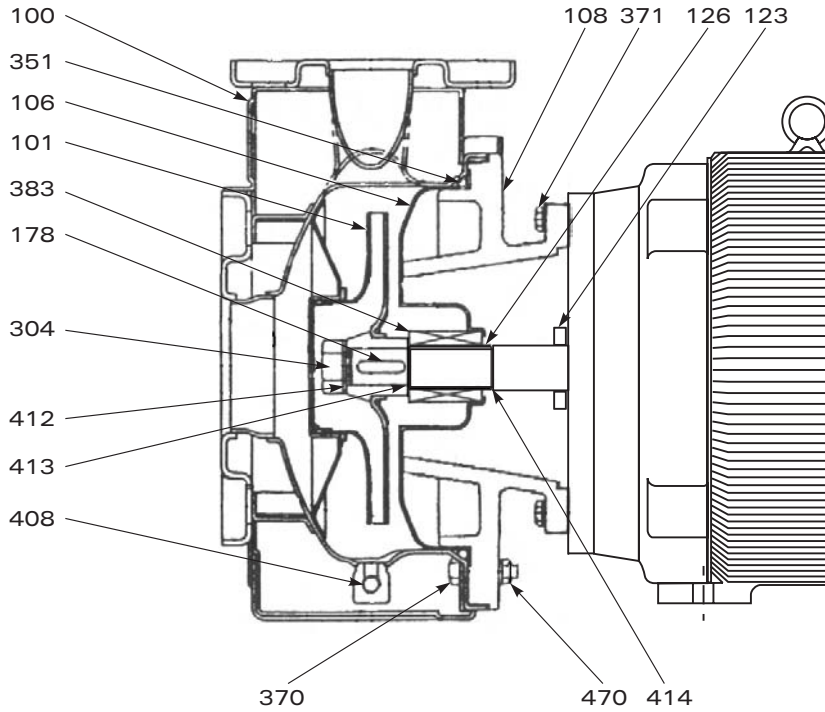

ITEM	QTY REQ'D	DESCRIPTION	MATERIAL
100	1	Casing	304 Stainless steel
101	1	Impeller	304 Stainless steel
106	1	Casing cover	304 Stainless steel
108	1	Adapter	Cast Iron
123	1	Slinger	Rubber
126	1	Shaft sleeve	304 Stainless steel
178	1	Impeller key	Steel
304	1	Impeller bolt	316 SS
351	1	Casing o-ring	Buna (standard)
370	*	Casing bolt	304 Stainless steel
371	4	Motor bolt	Steel
383	1	Mechanical seal	Various
408	1	Casing plug	304 Stainless steel
412	1	Impeller gasket	Teflon
413	1	Sleeve gasket	Teflon
414	1	Sleeve gasket	Teflon
470	*	Casing bolt nut	304 Stainless Steel

\* Dependent on pump model



# SERIES PS Specifications MODEL - PSF

Model PSF Selection Chart (1725 RPM)

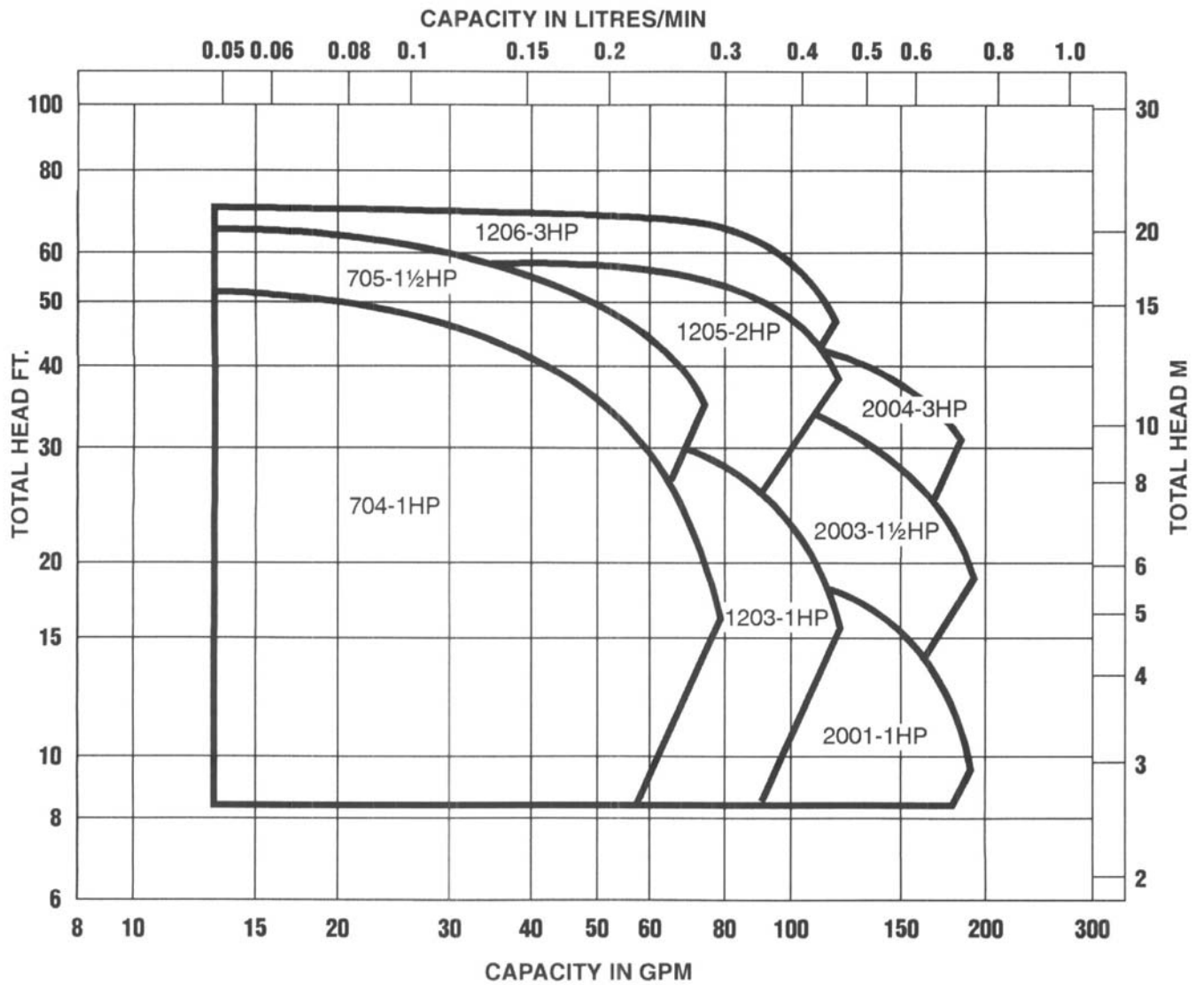



# SERIES PS Specifications MODEL - PSF

Model PSF Selection Chart (3450 RPM)

