



SERIES PG

INDUSTRIAL DUTY Self-Priming Diaphragm Pumps

Product Features

Cast aluminum construction.

Super durable thermoplastic rubber diaphragm.

3" FNPT ports.

1-5/8" solids handling.

Excellent self-primer.

Gasoline engine, electric and pneumatic drive options.

Flow rates up to 90 usgpm.

Units are wheel mounted for maximum portability.

The **MEGGA** line of mechanical diaphragm pumps features heavy duty gear reduction and ball bearing construction. These units are designed to pump mud, slurry, sewage and many more tough fluids and are available in various drive arrangements to suit your specific needs. Integral suction check valve ensures reliable priming to as much as 20 ft. Designed to operate at as many as 60 strokes per minute, flows of up to 90 usgpm can be achieved. Pumps come complete with 3" suction line strainer, hose connection nipples and are mounted on mobile carts with 10" semi-pneumatic wheels.

The **MEGGA** hand operated diaphragm pump is designed for basic transfer operations and is of bronze construction with stainless hardware and neoprene elastomers. Unit is mounted on an integral cast iron base and features 1-1/2" FNPT ports. Pump is self-priming to 20 ft. and will transfer 26 oz. of fluid per stroke.

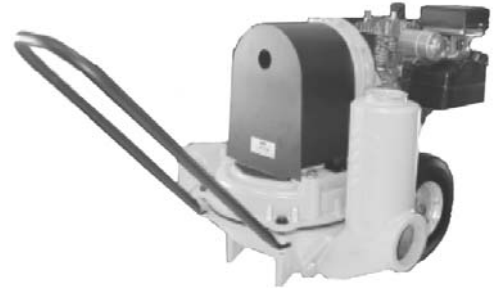

Performance Diaphragm Pumps

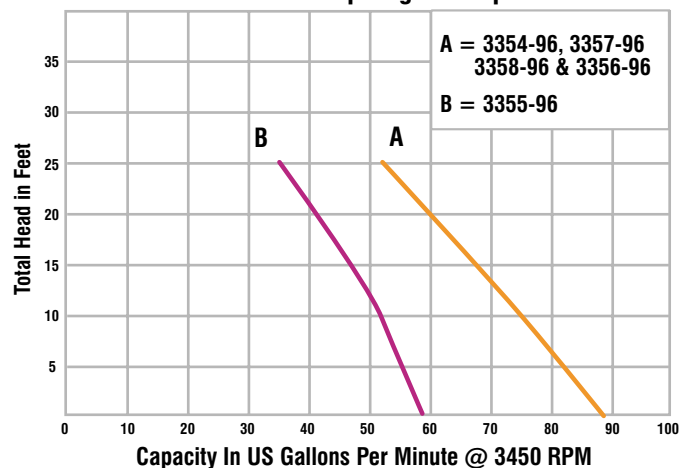

Diaphragm Pumps

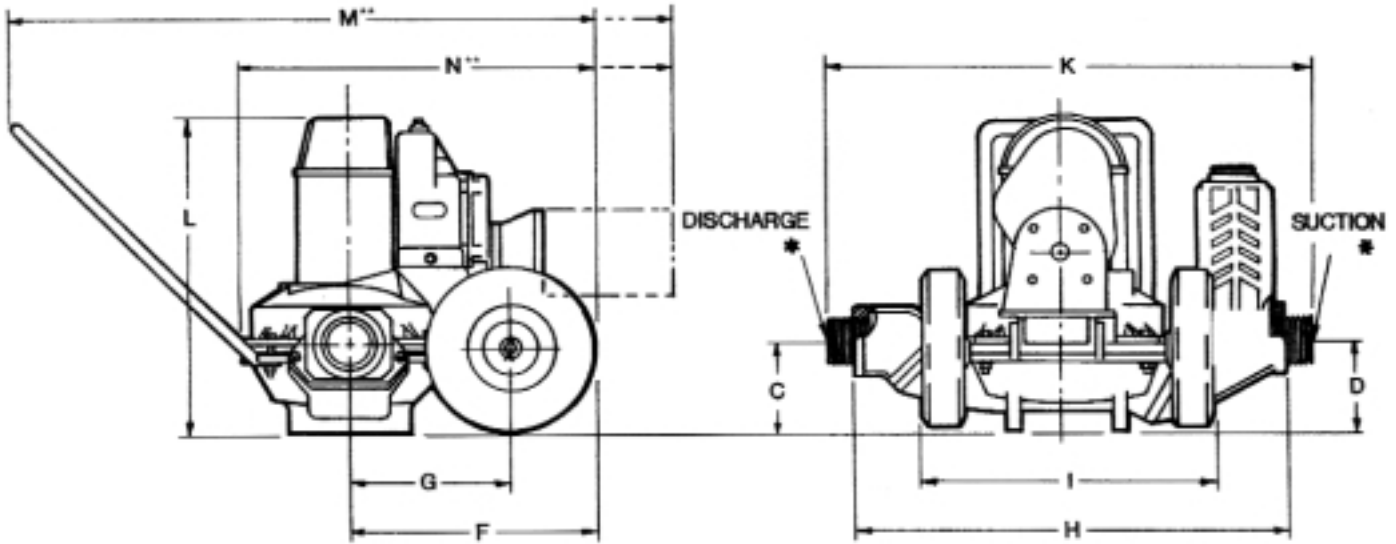

3354-96	3.5 hp B&S	3"	3"	6.2	6.3	14.5	9.5	26.5	17.9	30.0	22.0	41.5	25.5	171 lbs.
3355-96	1.5 hp ELEC. MOTOR	3"	3"	6.2	6.3	14.5	9.5	26.5	17.9	30.0	22.0	43.5	27.5	186 lbs.
3356-96	1.75 hp AIR MOTOR	3"	3"	6.2	6.3	14.5	9.5	26.5	17.9	30.0	22.0	37.0	21.0	151 lbs.
3357-96	5.5 hp B&S INTEK	3"	3"	6.2	6.3	14.5	9.5	26.5	17.9	30.0	22.0	41.5	25.5	181 lbs.
3358-96	5.5 hp HONDA GX	3"	3"	6.2	6.3	14.5	9.5	26.5	17.9	30.0	22.0	41.5	25.5	182 lbs.
3354-K6	KIT, LESS ENGINE	3"	3"	6.2	6.3	14.5	9.5	26.5	17.9	30.0	22.0	N/A	N/A	146 lbs.
3355-K6	KIT, LESS MOTOR	3"	3"	6.2	6.3	14.5	9.5	26.5	17.9	30.0	22.0	N/A	N/A	146 lbs.

(*) Standard NPT (female) pipe thread.

(**) This dimension may vary due to motor or engine manufacturer's specifications.

NOTE: Dimensions have a tolerance of $\pm 1/8"$.

Standard Features for MEGGA Diaphragm Pumps

- ▶ Engine Driven Models - Choice of Briggs & Stratton, Briggs & Stratton Intek, or Honda GX engines
- ▶ Model 3355-96 – 1.5 HP single phase, 115/230 Volt motor with manual reset overload includes 20 foot 115 VAC power cord and weatherproof on/off switch
- ▶ Model 3356-96 – 1.75 HP Gas Air Motor generates 6.5 to 57 inch pounds of torque and runs 300 to 3000 RPM's
- ▶ Model 3354-K6 – Kit, furnished less engine. For use with gasoline or diesel engines with .75" keyed shaft (SAE J609a Mounting Flange)
- ▶ Model 3355-K6 – Kit, furnished less motor. For use with electric motor (1725 RPM) or air motor with a minimum of 1.5 HP. 56C Mounting Flange required.

Standard Features for Model 4790-97

- ▶ Self-primers to 20 ft.
- ▶ Built in Handle Storage
- ▶ 26 oz. per Stroke
- ▶ Bronze Construction with Stainless Steel Hardware
- ▶ Neoprene Diaphragm and Flapper Valves
- ▶ 18" Brass Handle and Cast Iron Pumping Platform
- ▶ Shipping Weight: 32 Lbs.

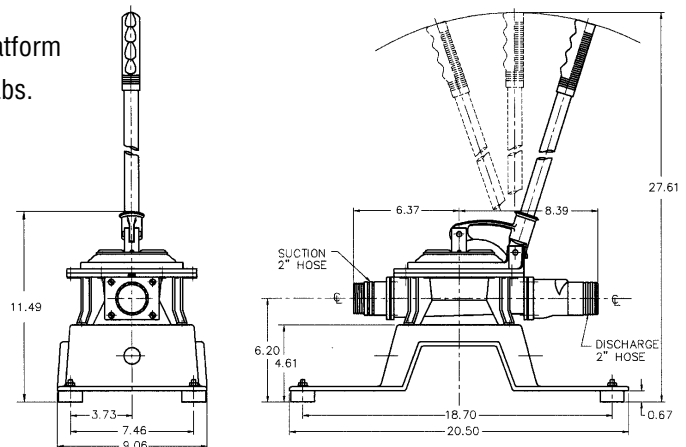

NOTE: All dimensions have a tolerance of $\pm 1/8"$

(*) 1 1/2" NPT (female) pipe thread or 2" ID Slip-on Hose.

NOTE: Dimensions have a tolerance of $\pm 1/8"$.

