



SERIES PG

INDUSTRIAL DUTY

Engine Driven Dredging Pump

Product Features

High chrome stainless steel internal wear components for use with abrasive slurries.

Silicon carbide mechanical seal.

Dual volute design reduces radial loads on engine.

75 psi maximum working pressure.

160 deg. F maximum temperature.

173 usgpm maximum flow.

100 ft maximum discharge head.

Handles up to 1/2" solids.

Self-priming up to 20 ft.

5.5 hp Honda OHV engine.

2" FNPT ports.

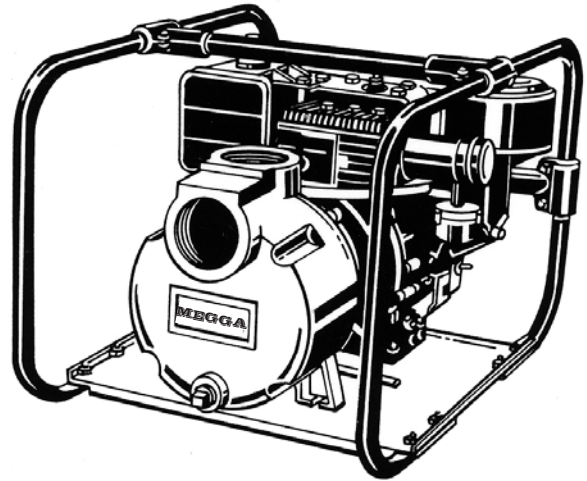

The **MEGGA** engine driven dredging pump is designed to handle water with up to 25% sand, debris and other abrasive particles. This unit can be used for a variety of industrial, agricultural, marine, commercial and municipal applications involving tough abrasive fluids.

This pump is constructed of wear resistant high chromium stainless steel and rugged cast iron. Components are investment cast and CNC machined for maximum efficiency and quality. Dual volute design ensures low radial loading on engine and shafting. Our dredging pump utilizes a high reliability and easy starting 5.5 hp Honda engine.

Designed for long lasting performance and easy economical maintenance, turn to **MEGGA** for tough slurry applications. For use with non-flammable fluids compatible with component materials.

Performance of 2" Dredging Pump

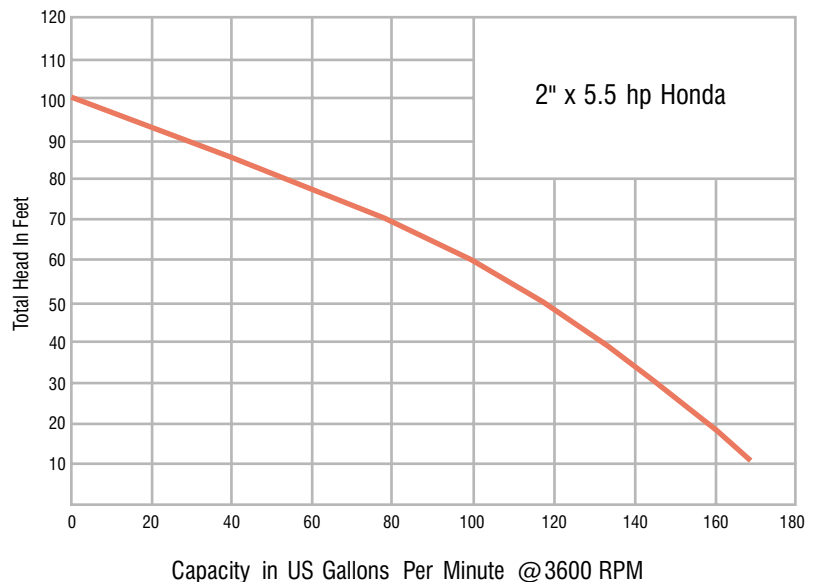

2" Engine Driven Dredging Pump

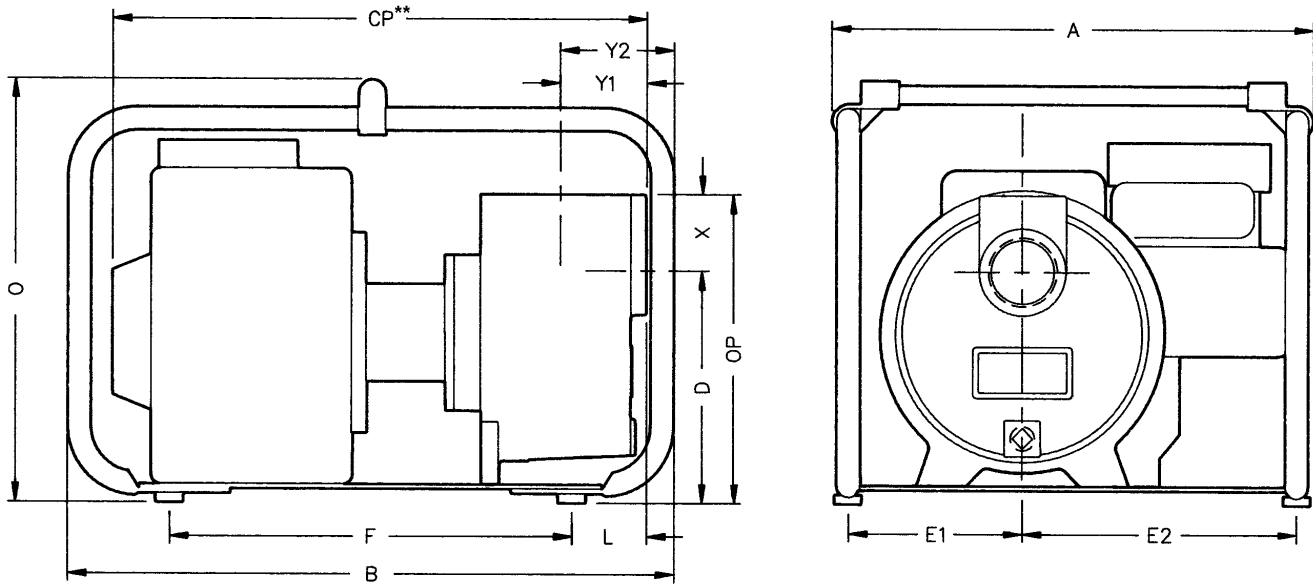

Pump Dimensional Data

Model No.	HP	A	B	CP**	D	E1	E2	F	L	O	OP	X	Y1	Y2
316F-95	5-1/2	17.0	22.0	19.0	6.8	5.0	10.0	8.5	6.0	19.3	9.5	2.6	3.1	4.6
316F-99	Min 5-1/2 Req'd	8.0	N/A	15.1	6.3	1.9	1.9	2.5	4.9	8.9	8.9	2.6	3.1	N/A

(**) This dimension may vary due to engine manufacturer's specifications.

NOTE: Dimensions have a tolerance of $\pm 1/8"$.

Model No.	Port Size	Driver	Construction	Seal	Run Time	Tank Size	Max Solids	Ship Wt.
316F-95	2" NPT	5.5 hp Honda GX160 OHV with Oil Alert	Cast Iron w/ High Chromium Stainless Steel Wear Parts	Silicon Carbide w/ Buna-N	100 min.	3.8 Qt	1/2"	85 lbs.
316F-99	2" NPT	Pedestal Ball Bearing w/3/4" Keyed Shaft	Cast Iron w/ High Chromium Steel Wear Parts	Silicon Carbide w/ Stainless Buna-N	N/A	N/A	1/2"	50 lbs.

Standard Features

- High Chromium Stainless Steel Internal Components Resists Wear from Sea Water Mixed with Abrasive Sand
- Silicon Carbide/Buna-N Mechanical Seal Resists Abrasives and Extends Seal Life
- Heavy Duty Cast Iron Casing and Adapter Insures Durability for Severe Service Conditions
- O-ring Casing Seal for Ease of Service and Cleaning
- Maximum Working Pressure 75 PSI
- Maximum Temperature 160° F
- Maximum Flow 173 GPM
- Maximum Head 101 ft. @ Sea Water (42 PSI)
- Handles up to 1/2" Diameter Solids
- Self-primers to 10 ft. in 1 Minute; Maximum 20 ft. lift
- Includes (2) NPT Pipe Nipples and Suction Strainer
- 5.5 HP Honda OHV Engine with Oil Alert

