



SERIES PG

INDUSTRIAL DUTY

Engine Driven Dewatering Pumps

Product Features

Available in cast iron, aluminum or thermoplastic construction.

Various elastomers and mechanical seals available.

1", 1.5" and 2" FNPT port sizes.

Semi-open clog resistant impeller self-prime to as much as 20 feet.

Available with 2 to 5.5 hp Briggs, Tecumseh or Honda engines.

Includes carry handle and steel base on cast iron and aluminum models.

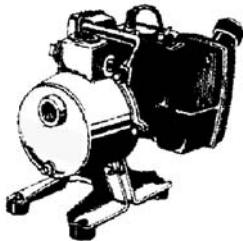
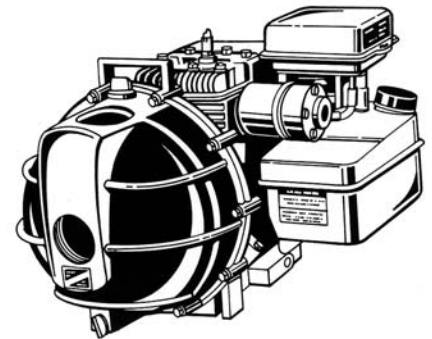
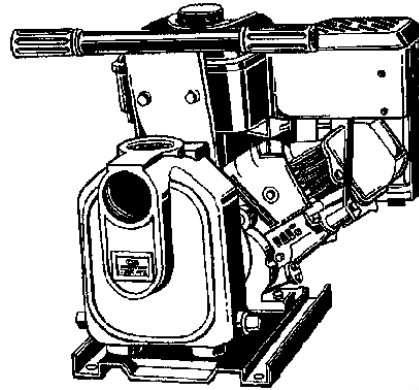

MEGGA engine driven dewatering pumps offer economy, durability, portability and performance.

Designed for general purpose dewatering, irrigation, spraying, washdown and other utility type applications for industrial, agricultural, municipal and commercial services.

MEGGA Series PG pumps are a reliable and cost effective option for all your fluid handling needs.

Performance of Engine Driven Dewatering Pumps

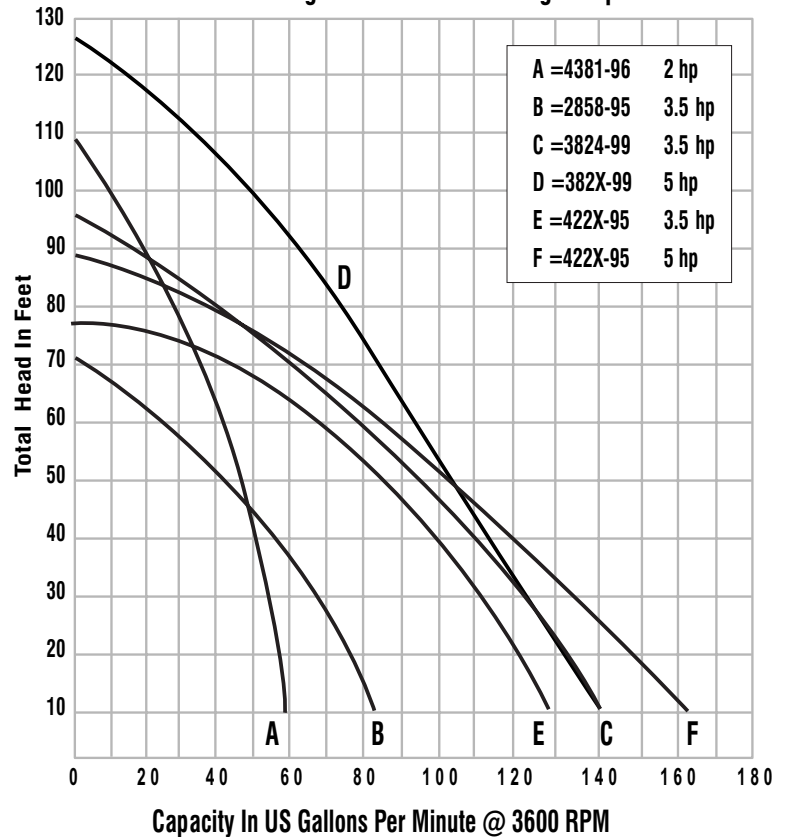



SERIES PG

INDUSTRIAL DUTY

Engine Driven Dewatering Pumps

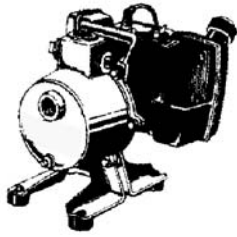

1" Dewatering Pump (2 Cycle)

Model#	Driver	Ship Wt.	Run Time	Tank Size
4381-96	2.0 hp TECUMSEH	18 lbs.	30 min.	20 oz.

Construction - Cast Aluminum

Solids Handling - 3/32"

Standard Features

- Two Garden Hose Adapters
- Buna-N Mechanical Seal
- O-Ring Casing Seal
- Self-priming to 15 ft. with Built in Check Valve
- Replaceable Volute
- Maximum Temperature 180° F
- Maximum Working Pressure 60 PSI
- Delivers up to 40 PSI and 2600 GPH (Maximum)

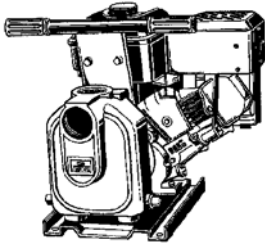

1-1/2" Dewatering Pump

Model#	Driver	Ship Wt.	Run Time	Tank Size
2858-95	3.5 hp B&S	57 lbs.	180 min.	3 qt.

Construction - Cast Iron

Solids Handling - 1/4"

Standard Features

- Two NPT Pipe Nipples
- Buna-N Mechanical Seal
- Optional Viton or Silicon Carbide Mechanical Seals
- Fiber Gasket Casing Seal
- Self-priming to 20 ft.
- Semi-Open, Clog Resistant Impeller
- Stainless Steel Shaft Sleeve
- Maximum Temperature 180° F
- Maximum Working Pressure 60 PSI
- Delivers up to 39 PSI and 9600 GPH (Maximum)
- Dual Volute Design

2" Dewatering Pumps

Model#	Driver	Ship Wt.	Run Time	Tank Size
4222-95	3.5 hp B&S	65 lbs.	180 min.	3 qt.
4223-95	5.5 hp B&S INTEK+	76 lbs.	90 min.	3 qt.
4226-95	5.5 hp HONDA+	65 lbs.	100 min.	3.8 qt.

Construction - Cast Iron

Solids Handling - 3/8"

+ Overhead Valve Engine (OHV)

Standard Features

- Two NPT Pipe Nipples
- Buna-N Mechanical Seal
- Optional EPDM Mechanical Seals Available
- O-Ring Casing Seal
- Self-priming to 20 ft. with Built in Check Valve
- Replaceable Volute
- Maximum Temperature 130° F
- Maximum Working Pressure 60 PSI
- Delivers up to 54 PSI and 8460 GPH (Maximum)

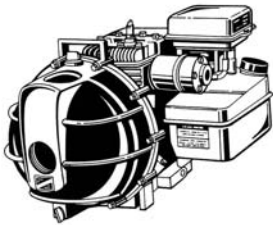

2" Dewatering Pumps

Model#	Driver	Ship Wt.	Run Time	Tank Size
3824-99	3.5 hp B&S	38 lbs.	180 min.	3 qt.
3825-99	5.5 hp B&S INTEK+	43 lbs.	90 min.	3 qt.
382A-99	5.0 hp HONDA+	45 lbs.	60 min.	1.8 qt.

Construction - Thermoplastic

Solids Handling - 7/16"

+ Overhead Valve Engine (OHV)

Standard Features

- Two NPT Pipe Nipples
- Buna-N Mechanical Seal
- Optional EPDM Mechanical Seals Available
- O-Ring Casing Seal
- Self-priming to 20 ft. with Built in Check Valve
- Replaceable Volute
- Maximum Temperature 130° F
- Maximum Working Pressure 60 PSI
- Delivers up to 54 PSI and 8460 GPH (Maximum)

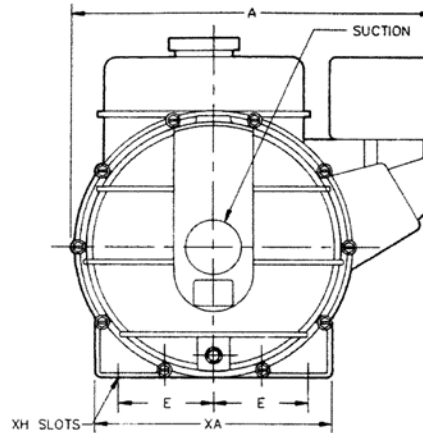
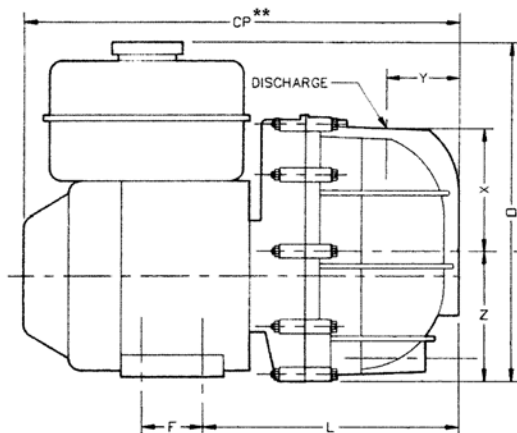

MODEL#	HP	A	XA	CP**	D	E	F	XH	L	O	X	Y	Z
2858-95	3.5	15.0	8.0	17.0	6.8	6.5	3.1	.40 X .40	9.3	13.2	2.2	2.8	7.1
3824-99	3.5	16.5	7.3	17.8	5.1	3.6	3.1	.44 X .64	8.3	13.2	4.8	2.8	5.5
3825-99	5.5	16.5	7.3	17.8	5.1	3.6	3.1	.44 X .64	8.3	13.2	4.8	2.8	5.5
382A-99	5.0	16.5	7.3	17.8	5.1	3.6	3.1	.44 X .64	8.3	13.2	4.8	2.8	5.5
4222-95	3.5	13.2	6.0	16.0	4.2	3.0	3.1	.40 X .40	9.5	16.8	1.5	4.2	9.2
4223-95	5.5	14.0	6.0	17.0	9.2	3.0	3.1	.40 X .40	9.5	17.8	1.5	3.8	9.2
4226-95	5.5	15.0	6.0	17.0	4.2	3.0	3.1	.40 X .40	9.5	17.0	1.5	4.2	9.2
4381-96	2.0	9.7	6.0	12.5	6.6	3.0	N/A	.40 X .40	9.0	11.0	3.7	2.9	6.5

(*) Standard NPT (female) pipe thread.

(**) This dimension may vary due to engine manufacturer's specifications.

NOTE: Dimensions have a tolerance of $\pm 1/8"$.